



UNLEY
Unit A 190 Unley Road

157 sqm

LANDMARK PROPERTY AVAILABLE FOR LEASE

Contact agent

This beautiful property is situated in the central hub of Unley occupying a prime corner location at the intersection of Arthur Street and Unley Road.

It is located perfectly between the Target department store and the refurbished and extended Unley Shopping Centre underpinning the quality of this precinct. Suitable for multiple uses (subject to council consent).

Ground floor:

- Corner of Unley Road and Arthur Street
- 85 sqm approx.
- Reception area
- Boardroom

Property ID	L27782390
Property Type	Offices
Building / Floor Area	157

AGENT

Michael Kourbelis

📞 0452 239 633

✉️ michael.kourbelis@sa.rhc.com.au

- Kitchen facilities + two toilets

- Air-conditioning

First floor:

- 54 sqm approx.

- Ample desk space

- Stunning wrap around balcony

- Air-conditioning

Total floor space 139 sqm approx.

Basement 18 sqm approx.

Available for \$70,000 per annum + GST + Outgoings (Approx \$8,757.00 per annum).

If you would like any further information or if you would like to view the property, please contact the leasing agent to arrange an inspection.

Michael Kourbelis 0452 239 633

RLA 283100

PARKING

fence

MetBx

SHED

dw

Ov

Hot Pl.

Drinks Fr.

3.0x4.7

UNIT C

7.4x19.2 (o/all)
ceiling: 2.6m.

UNIT C
ALFRESCO
DINING

Arthur Street

ac

bench

SwBd

UNIT B

4.0x5.2

3.0x5.2

ac

cupb

3.5x4.2

Hatch to
Basement

MetBx/SwBd

7.2x2.0

Coms

UNIT A

4.6x6.3

2.5x6.3

ac

ac

VERANDAH



190 Unley Road, Unley

ESTIMATED NETT LETTABLE AREA

Unit A (Grd. Floor)	85 sq. metres
Unit A (1st. Floor)	54 sq. metres
Unit A (Basement)	18 sq. metres
Unit B	51 sq. metres
Unit C	156 sq. metres

Total Nett L.A. 364 sq. metres

Al Fresco Dining 44 sq. metres

Complies with the PCA Method of Measurement

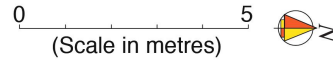

a/c outlets

Basement

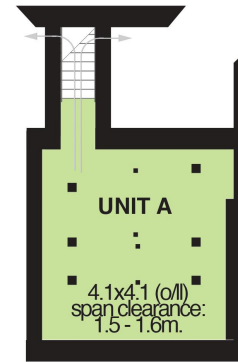

First Floor

